

STATE OF NORTH CAROLINA
DEPARTMENT OF TRANSPORTATION
HIGHWAY DIVISION 6

PLANS

Let Date: November 3, 2021

CONTRACT ID: DF00296

TIP NO.: -----

FEDERAL AID NO.: STATE FUNDED

WBS ELEMENT NO.: 2022CPT.06.10.20262.1

ROUTE NO.: VARIOUS SR

LOCATION: VARIOUS

COUNTY: CUMBERLAND

TYPE OF WORK: ASPHALT SURFACE TREATMENT – DOUBLE SEALS

LENGTH OF PROJECT: 49.288 MILES

**This electronic collection of documents is provided
for the convenience of the user
and is Not a Certified Document –**

**The documents contained herein were originally issued
and sealed by the individuals whose names and license
numbers appear on each page, on the dates appearing
with their signature on that page.**

**This file or an individual page
shall not be considered a certified document.**

Schedule of Quantities

Date: 10/6/2021
 Contract #: DF00296
 WBS: 2022CPT.06.10.20262.1

Division : 6
 County: Cumberland
 Description: AST - Double Seals

Map	SR	From	Begin MP	To	End MP	CL Length (Mile)	Width (Ft.)	Yardage (SY)	Treatment	WZ Signs (SF)	Emulsion (GAL)
1	SR 2023	NC 210	0.00	NC 53	2.68	2.680	20	34,590	Double	206	19,025
2	SR 2024	SR 2023	0.00	SR 1002	3.19	3.194	18	37,102	Double	235	20,406
3	SR 2025	NC 24	0.00	DEAD END	0.47	0.469	18	5,448	Double	84	2,996
4	SR 2026	SR 2027	0.00	SR 2028	1.47	1.473	20	19,012	Double	112	10,457
5	SR 2028	NC 210	0.00	SR 2030	2.68	2.684	24	41,570	Double	206	22,864
6	SR 2029	NC 210	0.00	DEAD END	0.77	0.765	20	9,874	Double	84	5,431
7	SR 2030	SR 2041	0.00	SAMPSON CO.	5.43	5.432	18	63,098	Double	360	34,704
8	SR 2031	NC 210	0.00	SR 2032	1.95	1.949	18	22,640	Double	112	12,452
9	SR 2032	NC 210	0.00	SR 2031	1.04	1.039	18	12,069	Double	112	6,638
10	SR 2033	SR 2032	0.00	SR 2034	2.12	2.117	20	27,323	Double	175	15,028
11	SR 2034	NC 210	0.00	SR 2035	1.19	1.192	18	13,846	Double	112	7,615
12	SR 2035	NC 210	0.00	SAMPSON CO.	2.46	2.455	18	28,517	Double	193	15,684
13	SR 2036	SR 2035	0.00	NC 242	3.37	3.368	18	39,123	Double	245	21,518
14	SR 2037	NC 210	0.00	SR 2036	1.08	1.079	18	12,534	Double	112	6,894
15	SR 2038	NC 242	0.00	BLADEN CO.	3.67	3.670	18	42,631	Double	262	23,447
16	SR 2040	NC 210	0.00	SR 2041	3.19	3.188	20	41,146	Double	235	22,630
17	SR 2041	NC 210	0.00	SR 1002	5.68	5.679	18	65,967	Double	374	36,282
18	SR 2042	SR 2041	0.00	SR 1002	1.80	1.801	18	20,920	Double	112	11,506
19	SR 2043	SR 1002	0.00	DEAD END	1.10	1.101	20	14,210	Double	84	7,816
20	SR 2044	SR 1002	0.00	DEAD END	1.26	1.264	22	17,945	Double	84	9,870
21	SR 2046	SR 1002	0.00	DEAD END	1.12	1.115	20	14,391	Double	84	7,915
22	SR 2048	BLADEN CO.	0.00	NC 210	0.31	0.313	20	4,040	Double	112	2,222
23	SR 2052	SR 2026	0.00	DEAD END	0.30	0.304	16	3,139	Double	112	1,726
24	SR 2053	NC 210	0.00	NC 210	0.64	0.639	25	10,309	Double	84	5,670
25	SR 2054	NC 210	0.00	SR 2040	0.21	0.210	18	2,439	Double	112	1,341
26	SR 2055	NC 210	0.00	END MAINTENANCE	0.11	0.108	18	1,255	Double	112	690
TOTALS:						49.288		605,138		4,115	332,827

Date: 10/6/2021
 Contract #: DF00296
 WBS: 2022CPT.06.10.20262.1
 Division : 6
 County: Cumberland
 Description: AST - Double Seals

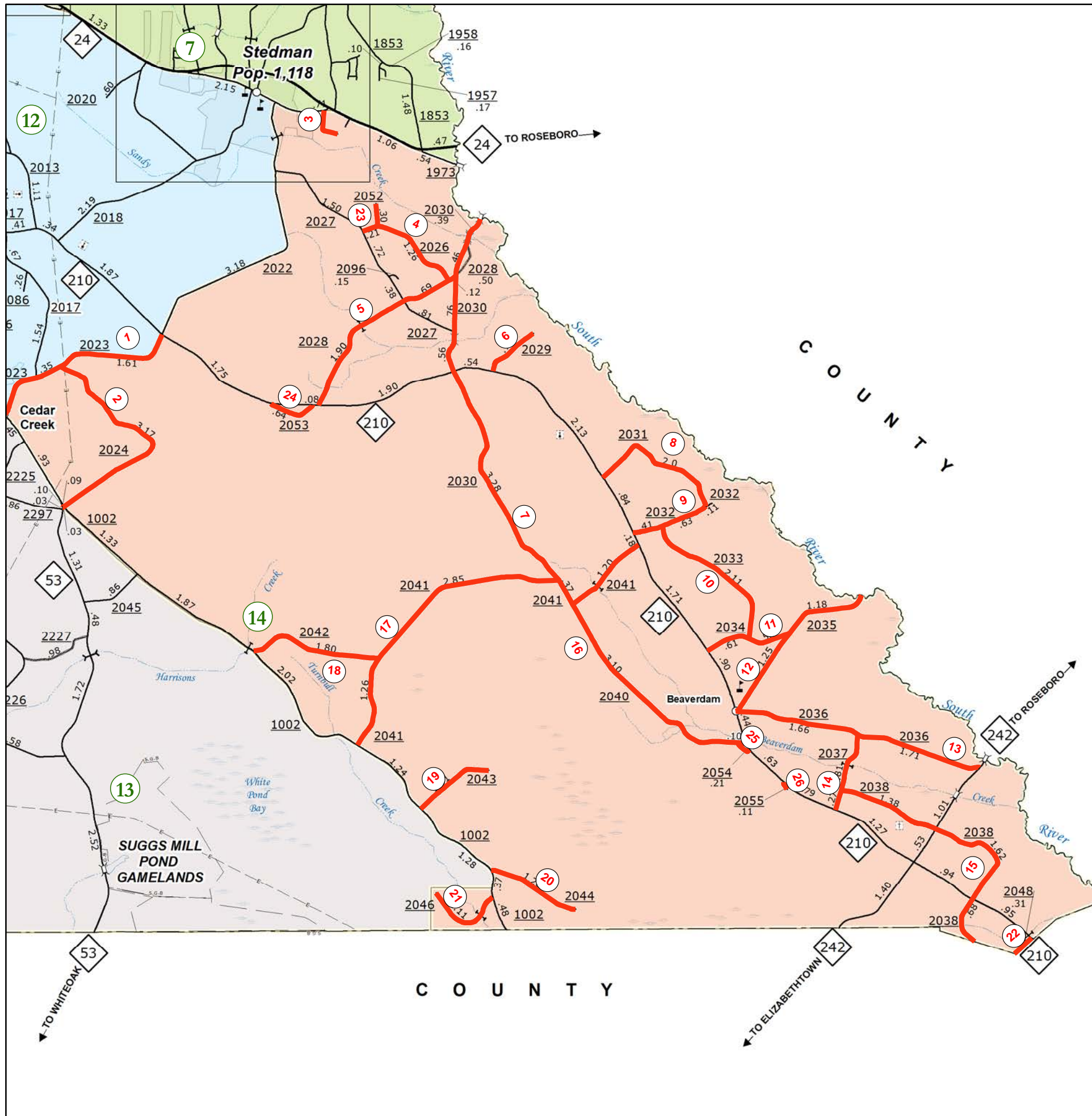

Map	SR	From	Begin MP	To	End MP	CL Length (Mile)	Width (Ft.)	Yardage (SY)	Treatment	WZ Signs (SF)	Emulsion (GAL)
1	SR 2023	NC 210	0.00	NC 53	2.68	2.680	20	34,590	Double	206	19,025
2	SR 2024	SR 2023	0.00	SR 1002	3.19	3.194	18	37,102	Double	235	20,406
3	SR 2025	NC 24	0.00	DEAD END	0.47	0.469	18	5,448	Double	84	2,996
4	SR 2026	SR 2027	0.00	SR 2028	1.47	1.473	20	19,012	Double	112	10,457
5	SR 2028	NC 210	0.00	SR 2030	2.68	2.684	24	41,570	Double	206	22,864
6	SR 2029	NC 210	0.00	DEAD END	0.77	0.765	20	9,874	Double	84	5,431
7	SR 2030	SR 2041	0.00	SAMPSON CO.	5.43	5.432	18	63,098	Double	360	34,704
8	SR 2031	NC 210	0.00	SR 2032	1.95	1.949	18	22,640	Double	112	12,452
9	SR 2032	NC 210	0.00	SR 2031	1.04	1.039	18	12,069	Double	112	6,638
10	SR 2033	SR 2032	0.00	SR 2034	2.12	2.117	20	27,323	Double	175	15,028
11	SR 2034	NC 210	0.00	SR 2035	1.19	1.192	18	13,846	Double	112	7,615
12	SR 2035	NC 210	0.00	SAMPSON CO.	2.46	2.455	18	28,517	Double	193	15,684
13	SR 2036	SR 2035	0.00	NC 242	3.37	3.368	18	39,123	Double	245	21,518
14	SR 2037	NC 210	0.00	SR 2036	1.08	1.079	18	12,534	Double	112	6,894
15	SR 2038	NC 242	0.00	BLADEN CO.	3.67	3.670	18	42,631	Double	262	23,447
16	SR 2040	NC 210	0.00	SR 2041	3.19	3.188	20	41,146	Double	235	22,630
17	SR 2041	NC 210	0.00	SR 1002	5.68	5.679	18	65,967	Double	374	36,282
18	SR 2042	SR 2041	0.00	SR 1002	1.80	1.801	18	20,920	Double	112	11,506
19	SR 2043	SR 1002	0.00	DEAD END	1.10	1.101	20	14,210	Double	84	7,816
20	SR 2044	SR 1002	0.00	DEAD END	1.26	1.264	22	17,945	Double	84	9,870
21	SR 2046	SR 1002	0.00	DEAD END	1.12	1.115	20	14,391	Double	84	7,915
22	SR 2048	BLADEN CO.	0.00	NC 210	0.31	0.313	20	4,040	Double	112	2,222
23	SR 2052	SR 2026	0.00	DEAD END	0.30	0.304	16	3,139	Double	112	1,726
24	SR 2053	NC 210	0.00	NC 210	0.64	0.639	25	10,309	Double	84	5,670
25	SR 2054	NC 210	0.00	SR 2040	0.21	0.210	18	2,439	Double	112	1,341
26	SR 2055	NC 210	0.00	END MAINTENANCE	0.11	0.108	18	1,255	Double	112	690
TOTALS:						49.288		605,138		4,115	332,827

Legend

— Double Seal

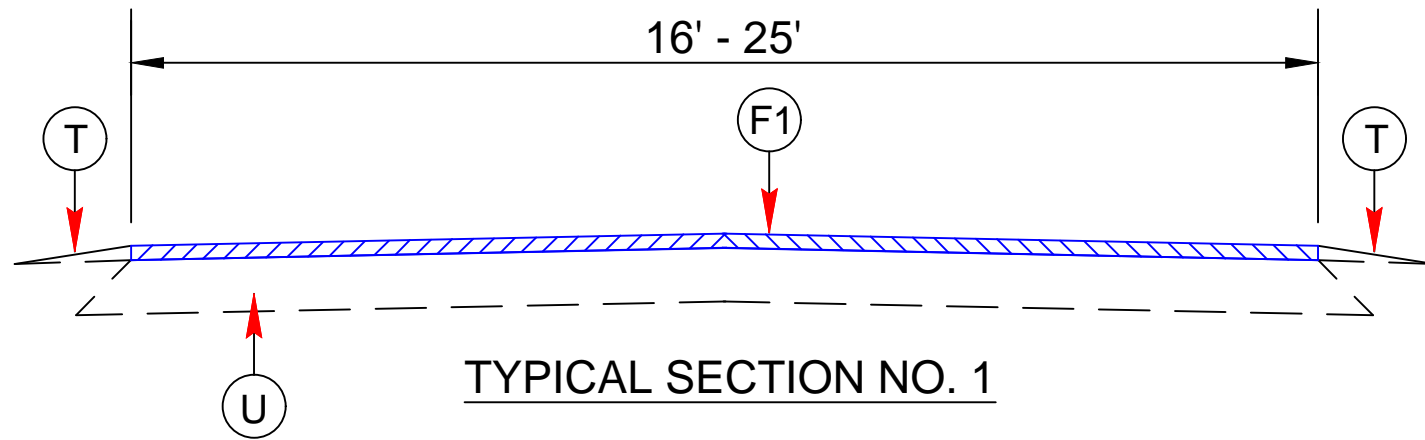

PAVEMENT SCHEDULE	
F1	DOUBLE SEAL PLACED ACCORDING TO THE SPECIAL PROVISIONS
T	EXISTING SHOULDER
U	EXISTING ASPHALT

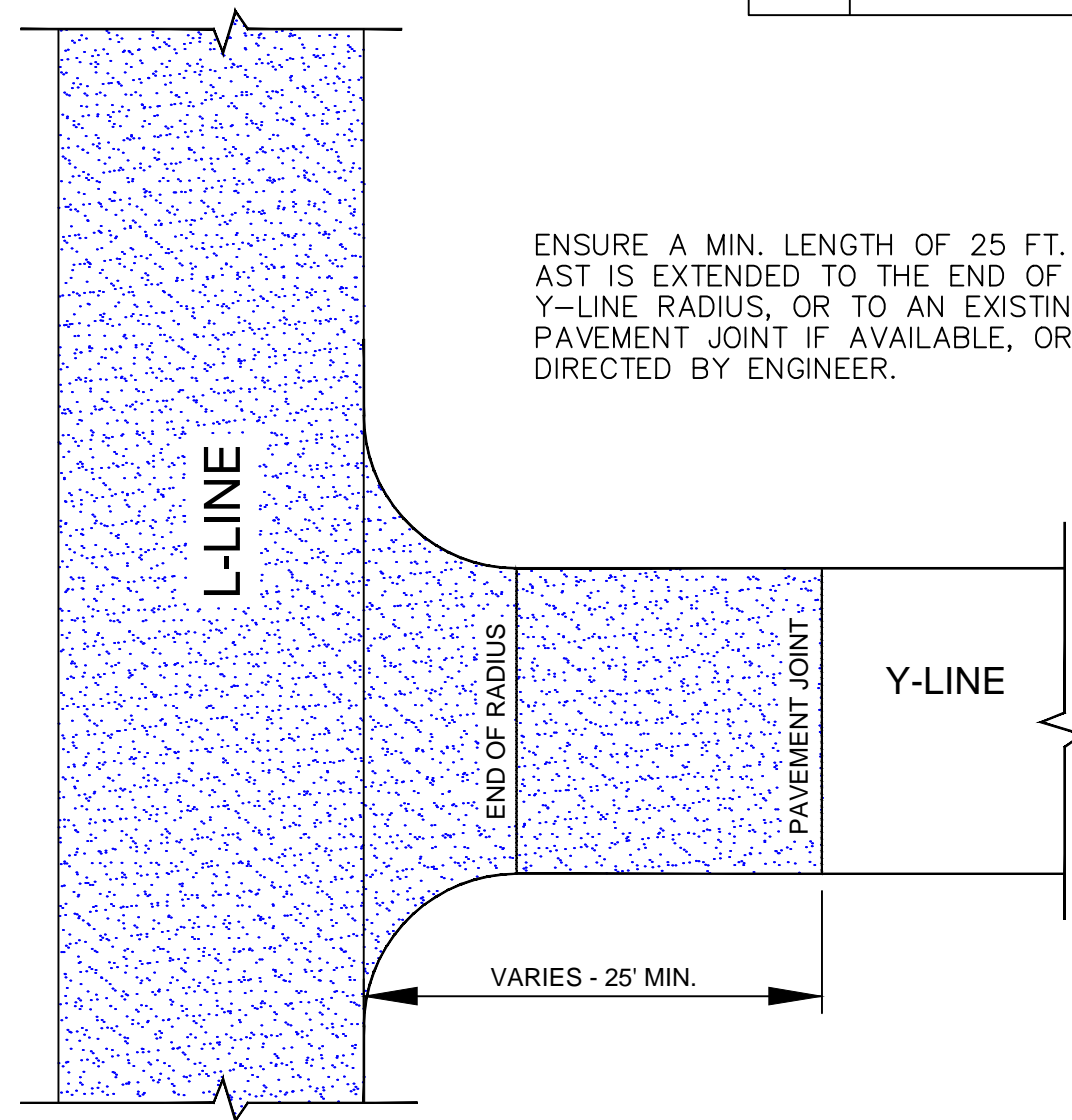

ENSURE A MIN. LENGTH OF 25 FT. OF AST IS EXTENDED TO THE END OF THE Y-LINE RADIUS, OR TO AN EXISTING PAVEMENT JOINT IF AVAILABLE, OR AS DIRECTED BY ENGINEER.

SIGNING FOR ASPHALT SURFACE TREATMENT

LEGEND

- PORTABLE SIGN
- STATIONARY SIGN
- DIRECTION OF TRAFFIC FLOW

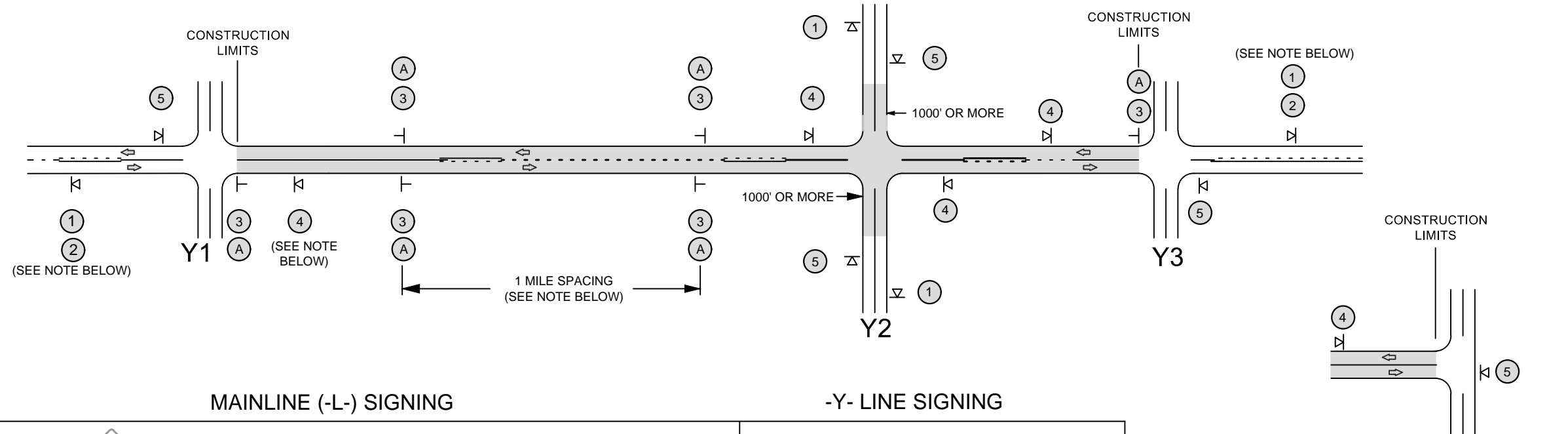

MAINLINE (-L-) SIGNING

-Y- LINE SIGNING

SIGNING NOTES AND PLACEMENT PER DIRECTION	<p>① ROAD WORK AHEAD W20-1 48" X 48"</p> <p>② NEXT XX MILES W7-3aP 24" X 18"</p>	<p>- PLACE 1000' PRIOR TO BEGINNING OF CONSTRUCTION LIMITS. ONLY USED ON -Y- LINES IF RESURFACING LIMITS EXTEND 1000' ALONG -Y- LINE.</p> <p>- SIGN #2 ONLY USED WHEN RESURFACING LIMITS ARE 2 OR MORE MILES IN LENGTH. ROUND UP TO THE NEAREST WHOLE NUMBER. DO NOT USE FRACTIONAL OR DECIMAL NUMBERS.</p>
	<p>③ LOOSE GRAVEL W8-7 48" X 48"</p> <p>UNMARKED PAVEMENT SP 48" X 48"</p>	<p>- ALTERNATE THE FOLLOWING TWO SIGNS:</p> <p>- STARTING WITH "LOOSE GRAVEL" (W8-7) FOLLOWED BY "UNMARKED PAVEMENT".</p> <p>- PLACE INITIALLY AT THE CONSTRUCTION LIMITS AND SPACED 1 MILE APART THEREAFTER.</p> <p>- AT TEE INTERSECTIONS INSTALL INITIALLY 0.5 MILE FROM INTERSECTION AND SPACE 1 MILE APART THEREAFTER.</p>
	<p>A SPEED LIMIT 35 W13-1P 18" X 18"</p>	<p>PLACE INITIALLY AT THE CONSTRUCTION LIMITS AND SPACED 1 MILE APART THEREAFTER. IF NO -Y- LINES EXIST, PLACE 2ND SET 1/2 MILE FROM THE CONSTRUCTION LIMITS AND THEN SPACE 1 MILE THEREAFTER. SPEED LIMIT SIGN MAY BE PLACED ON SAME POST AS LOOSE GRAVEL SIGN, IF DESIRED.</p>
	<p>④ ROAD UNDER CONST SP 13106 48" X 48"</p>	<p>- THESE ARE FOR -Y- LINES THAT ARE "THROUGH" ROADWAYS. DEAD END AND SUBDIVISION ROADS ARE NOT "THROUGH" ROADWAYS.</p> <p>- INSTALL 500' +/- FROM EACH -Y- LINE APPROACH AS SHOWN ABOVE.</p> <p>- FOR MULTIPLE -Y- LINES THAT ARE SEPARATED BY 0.25 MILES OR LESS, TREAT AS A SINGLE UNIT AND INSTALL WITHIN 500' OF EACH APPROACH.</p> <p>- A MAXIMUM OF 2 SIGN SETS PER MILE. DO NOT INSTALL WHEN -Y- LINES ARE WITHIN 0.5 MILES FROM "END ROAD WORK" SIGN.</p>
	<p>⑤ END ROAD WORK G20-2 A 48" X 24"</p>	<p>PLACE 500' FOLLOWING THE END OF CONSTRUCTION LIMITS OR AS SHOWN WHEN WORK ENDS AT A 3-WAY TEE INTERSECTION.</p>

STATIONARY SIGNING NOT REQUIRED FOR THE FOLLOWING -Y- LINE CONDITIONS:

- LESS THAN 1000' OF RESURFACING ALONG -Y- LINE
- SUBDIVISION ROADS
- DEAD END ROADS

WHEN PAVING/CONSTRUCTION ACTIVITIES PROCEED ACROSS AN UNSIGNED -Y- LINE, PORTABLE ADVANCE WARNING SIGNS SHALL BE USED ALONG THE -Y- LINE AS SHOWN BELOW. REMOVE UPON COMPLETION OF WORK.

PLACED 500' IN ADVANCE OF FLAGGER.

PLACED 250' IN ADVANCE OF FLAGGER.

NOTE:
IT IS THE CONTRACTOR'S RESPONSIBILITY TO ENSURE THE PROPER PLACEMENT AND LOCATION OF WORK ZONE SIGNING PER THE STANDARD DRAWING. NCDOT HAS THE RIGHT TO INSPECT THE PLANNED LOCATIONS AND REQUIRE ADJUSTMENT BY THE CONTRACTOR, AS NEEDED, OR AS DIRECTED BY THE ENGINEER.

MAPS LESS THAN 2 MILES

FOR AST RESURFACING MAPS WITH CONSTRUCTION LIMITS LESS THAN 2 MILES IN LENGTH, USE A STATIONARY "LOOSE GRAVEL" SIGN AT THE BEGINNING CONSTRUCTION LIMIT FOLLOWED BY AN "UNMARKED PAVEMENT" SIGN MIDWAY THROUGH AND AN "END ROAD WORK" SIGN AT THE END CONSTRUCTION LIMIT.

REVISED - 12-13-2018

NCDOT - DIVISION 6

ADVANCE WARNING SIGNS FOR 2-LANE ROADWAY ASPHALT SURFACE TREATMENT

